



FD460

Folding Door System

A wide variety of solutions of unrivaled functionality.



System Identity

FD460 is the non-thermal insulating system for folding doors, the ideal solution for wide spans, providing excellent sealing and connecting harmoniously the interior with the exterior environment.

Features & Benefits

- Hanging on top guide using a special roller-hinge, able to support 200 Kg (100 Kg per sash).
- Sealing with both EPDM gaskets and high-density brushes.
- Low threshold for comfortable access and passage.
- Possibility of locking door construction, opening inwards.

Configurations

Folding: 3Leaf, 5Leaf, 7Leaf

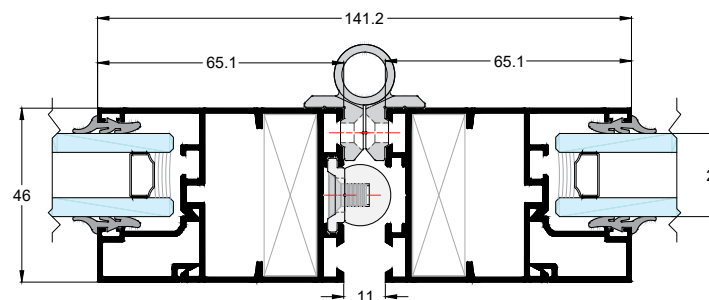

SYSTEM PROFILE DIMENSIONS

MIN. RAIL WIDTH mm	54.5
MIN. FRAME HEIGHT mm	22
MIN. FACE HEIGHT mm	79
GLASS THICKNESS mm	4-31

CONSTRUCTION DIMENSIONS

SASH WIDTH mm	350-800
SASH HEIGHT mm	600-2300
MAX. SASH DIMENSIONS mm (WxH)	700x2300
MAX. SASH WEIGHT Kg	100



FLAT